

# Explosion Drawing

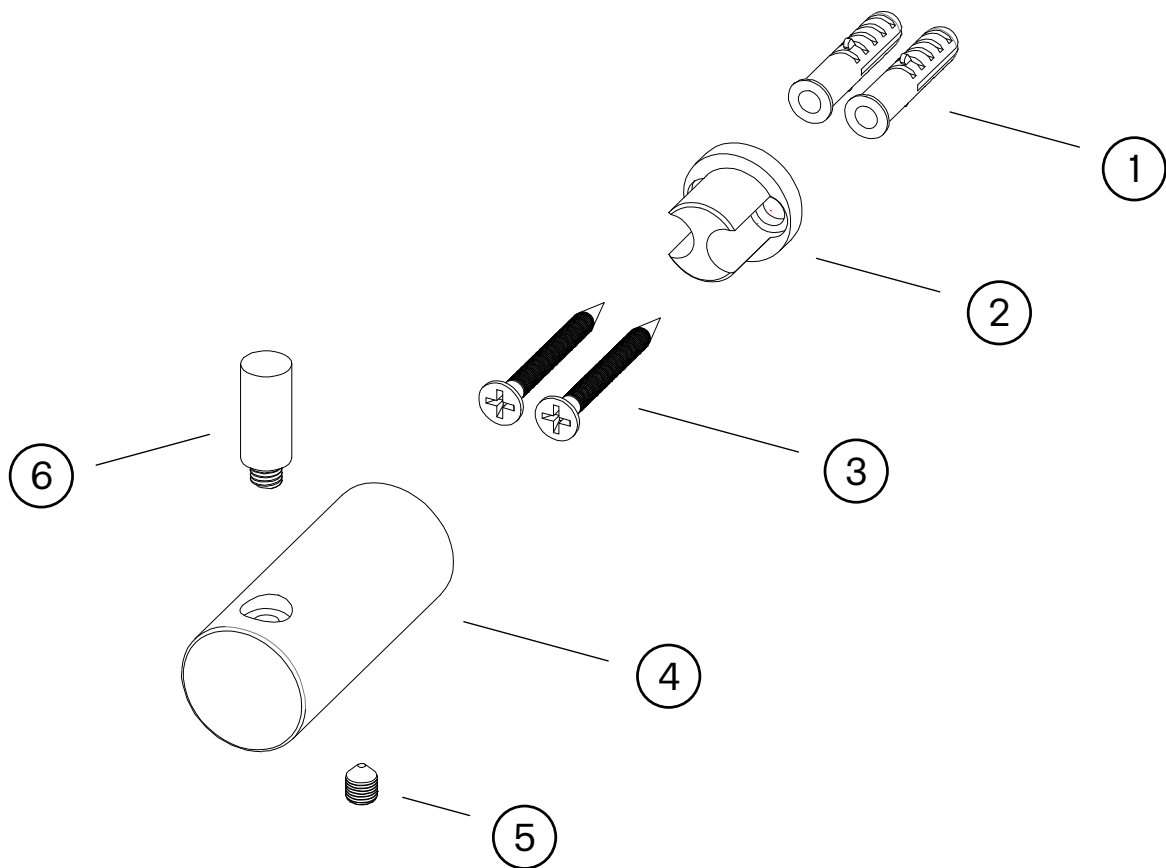

1. Screw plug  $\text{\O}6 \times 30 \text{ mm}$
2. Screw attachment  $\text{\O}19 \times 16,5 \text{ mm}$
3. Screw  $\text{M4} \times 35 \text{ mm}$
4. Hook  $\text{\O}15 \times 30 \text{ mm}$
5. Allan screw  $\text{M5} \times 6 \text{ mm}$
6. Knob  $\text{\O}8 \times 21,4 \text{ mm}$